

Specifications

Port Sizes	½", ¾", 1"
Thread Styles	NPT, BSPT, BSPP
Flow Capacity	90/ 150 scfm @ 100 PSI
Filter Capacity	1.0 Micron & larger
Differential Pressure	< 5.0 PSID at rated flow
Max Temp/ Pressure	
Aluminum Bowl	175°F/200 PSIG
Max Temp/ Pressure	
Polycarbonate Bowl	125°F/150 PSIG
Approx. Weight (lb.)	6.0
ISO Class	2 Particulate

For higher pressure applications, consult factory.
Units equipped with differential pressure indicator have max temperature and pressure of 125°F and 150 PSIG, regardless of bowl material.



Water
Dirt
Oil
Oil Vapor
Odor

Replacement Parts & Accessories

Description	Part Number
A Replacement Element	BW090BW150
B Differential Pressure Indicator	N32-W1-DPI
B Blanking Cap (Cover for Indicator)	N32-95-020
C Bowl Assembly: Metal Bowl, Manual Petcock Drain, & O-ring	N34-15-180
C Bowl Assembly: Metal Bowl, Auto Float Drain & O-ring	N34-15-178
D Bowl Assembly: Poly Bowl, Manual Petcock Drain, & O-ring*	N32-15-167
D Bowl Assembly: Poly Bowl, Auto Float Drain, & O-ring*	N32-15-166
E Manual Petcock Drain (Metal Bowl)	PC-03
E Manual Petcock Drain (Poly Bowl)	N32-95-182
F Automatic Plastic Float Drain (Metal Bowl)	N32-95-979
F Automatic Brass Float Drain (Poly Bowl)	N32-95-978
G Bowl O-ring	N32-95-256

*Poly bowls come with metal bowl guard

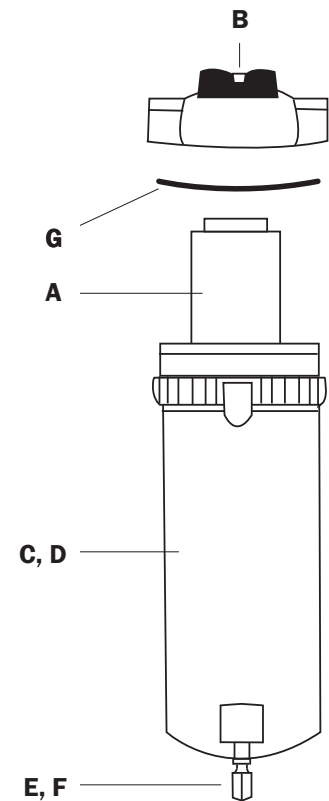

Order Guide

	Port Size	Model Number			
		Metal Bowl		Poly Bowl	
		Low Flow	Med Flow	Low Flow	Med Flow
Manual Brass Petcock Drain	½"	BW090M04M	BW150M04M	BW090P04M	BW150P04M
	¾"	BW090M06M	BW150M06M	BW090P06M	BW150P06M
	1"	BW090M08M	BW150M08M	BW090P08M	BW150P08M

Automatic Float Drain	½"	BW090M04A	BW150M04A	BW090P04A	BW150P04A
	¾"	BW090M06A	BW150M06A	BW090P06A	BW150P06A
	1"	BW090M08A	BW150M08A	BW090P08A	BW150P08A

Dimensions (inches)			
Height*		Width	Depth
Metal	Poly		
17.0	14.0	4.6	4.8
17.0	14.0	4.6	4.8
17.0	14.0	4.6	4.8

17.0	14.5	4.6	4.8
17.0	14.5	4.6	4.8
17.0	14.5	4.6	4.8

*To add an indicator, add "i" to end of model number (Indicator adds about 1" to height)

BEHRINGER®